

DS-K1T643-T Series MinMoe Terminal Release Note (2021-04-26)

Device Model: DS-K1T643MX-T DS-K1T643MWX-T	Firmware Version	ARM: ACS_640A_3XF_AI2_EN_STD_V3.2.2_build210331 ACS_640A_3XF_AI2_EN_NEU_V3.2.2_build210331
	SDK	V6.1.4.16_build20200319
Naming Rule: W for Wi-Fi	iVMS-4200 Version	Latest version

Reason of Upgrade

New temperature screening MinMoe terminal DS-K1T643M(W)X-T terminals first time released.



New Features

1. Brand new appearance and hardware design
2. 4.3-inch LCD touch screen, 2 MP wide-angle dual-lens camera;
3. **Temperature screening and face mask detection related function**
Vanadium Oxide uncooled sensor to measure forehead temperature:
range: 30 °C to 45 °C (86 °F to 113 °F)
resolution: 90*120
accuracy: 0.1 °C
deviation: ± 0.5 °C (±0.3 °C with black body, purchased separately)
Recognition distance: 0.3 to 2 m
4. Connect external card reader or access controller via RS485 or Wiegand26/34 protocol
5. Face recognition duration < 0.2 s/User; face recognition accuracy rate ≥ 99%
6. Built-in Mifare 1 card reading module
7. **Face, card and event capacity**

	Face	Card	Event	Wi-Fi
DS-K1T643MX-T	6,000	10,000	150,000	N/A
DS-K1T643MWX-T				Support

8. **ISAPI** protocol makes it easier to integrate with third-party software;

- 9. Remote video intercom and unlock door from **Hik-Connect** App on your mobile/Pad
- 10. Support **ISUP 5.0** protocol to manage devices located in different location;

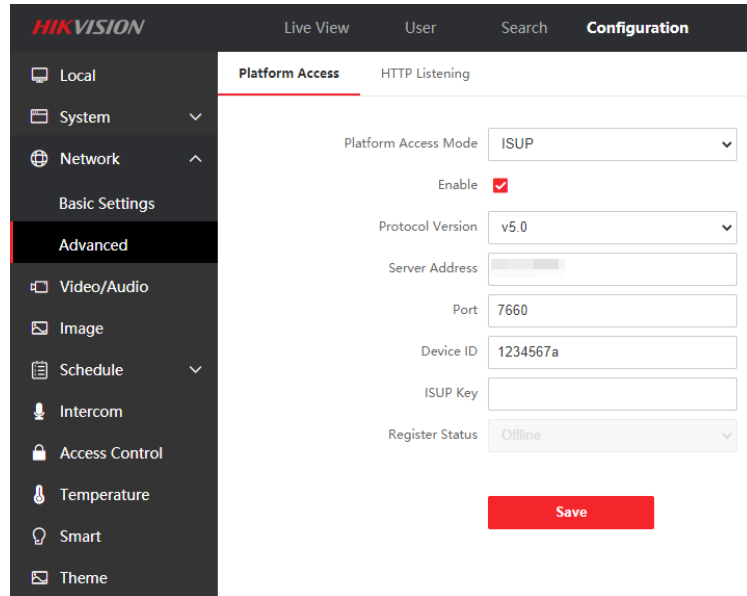

- 11. Self-defined shortcut key (Call and Password) on main interface, **call Hik-Connect** App.

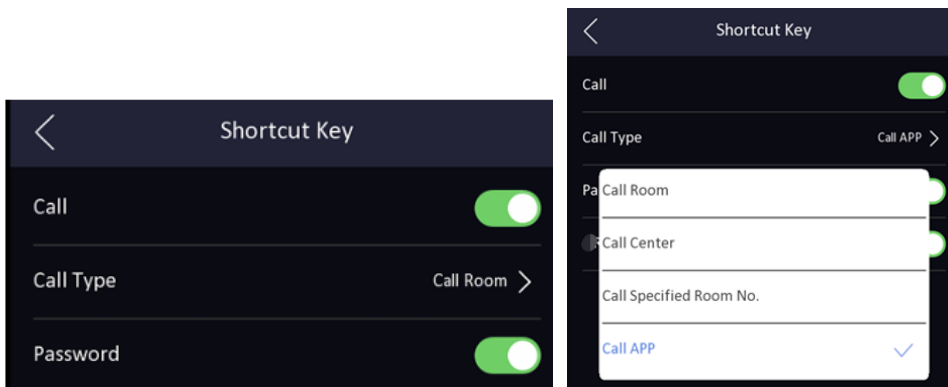

Note: Hik-Connect function is disabled in default for privacy protection, if customer want to manage device from App, please turn on manually in the web

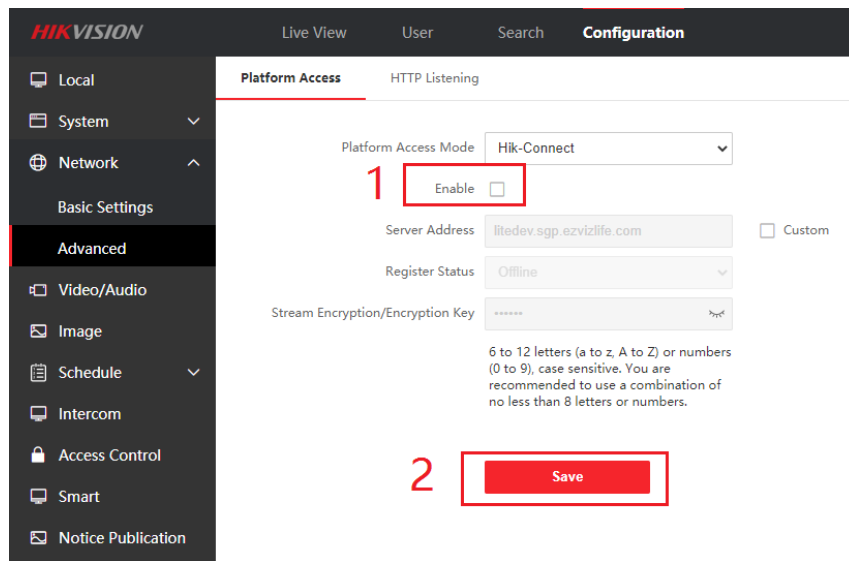

12. Login and configure device in **web client** via browser to realize person management, parameter configuration, log search and system maintenance;

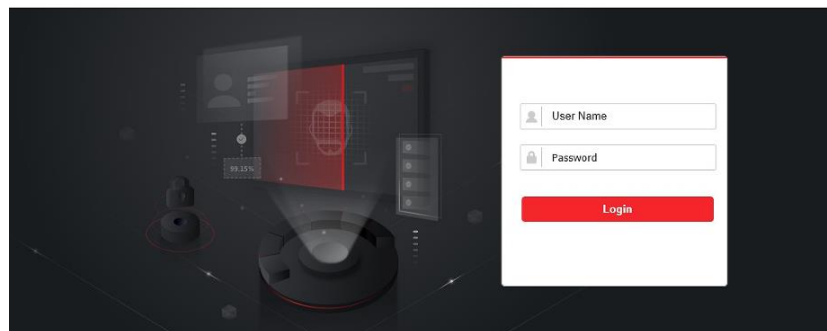

13. **Self-defined voice prompt** (TTS function, English only) and **screen display info** (user ID, name and face picture, temperature) for authentication result, set different voice prompts maximum for 4 time periods.

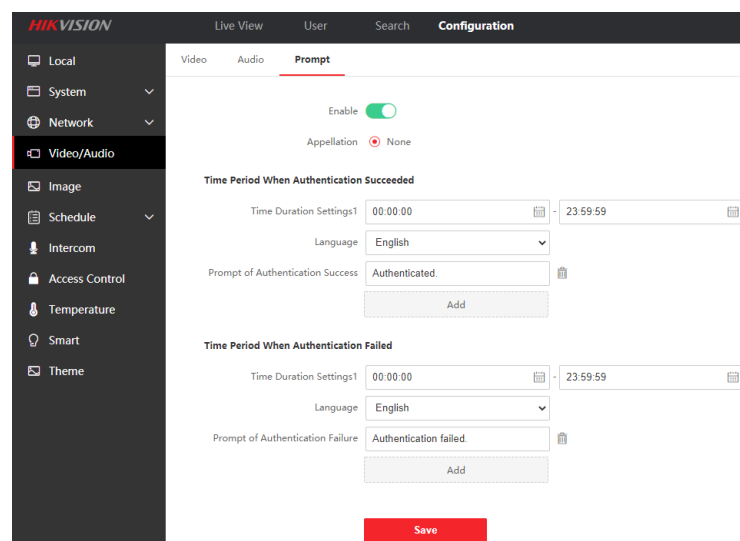

14. Support **simple mode** (disabled in default), after enable, it will not display live view when verify

face

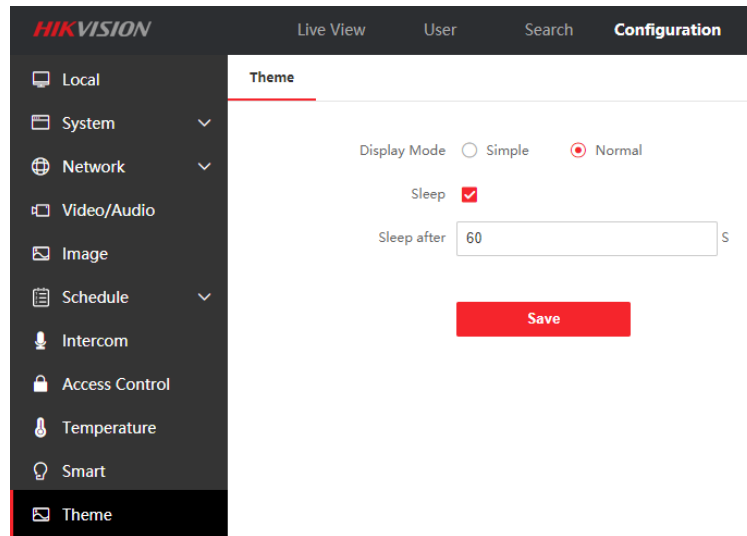

- Support **privacy protection**, customer can define the privacy related parameter, such as whether to display photo, name, ID number, temperature after verification, Event Storage Settings, Picture Uploading and Storage, Clear All Pictures in Device

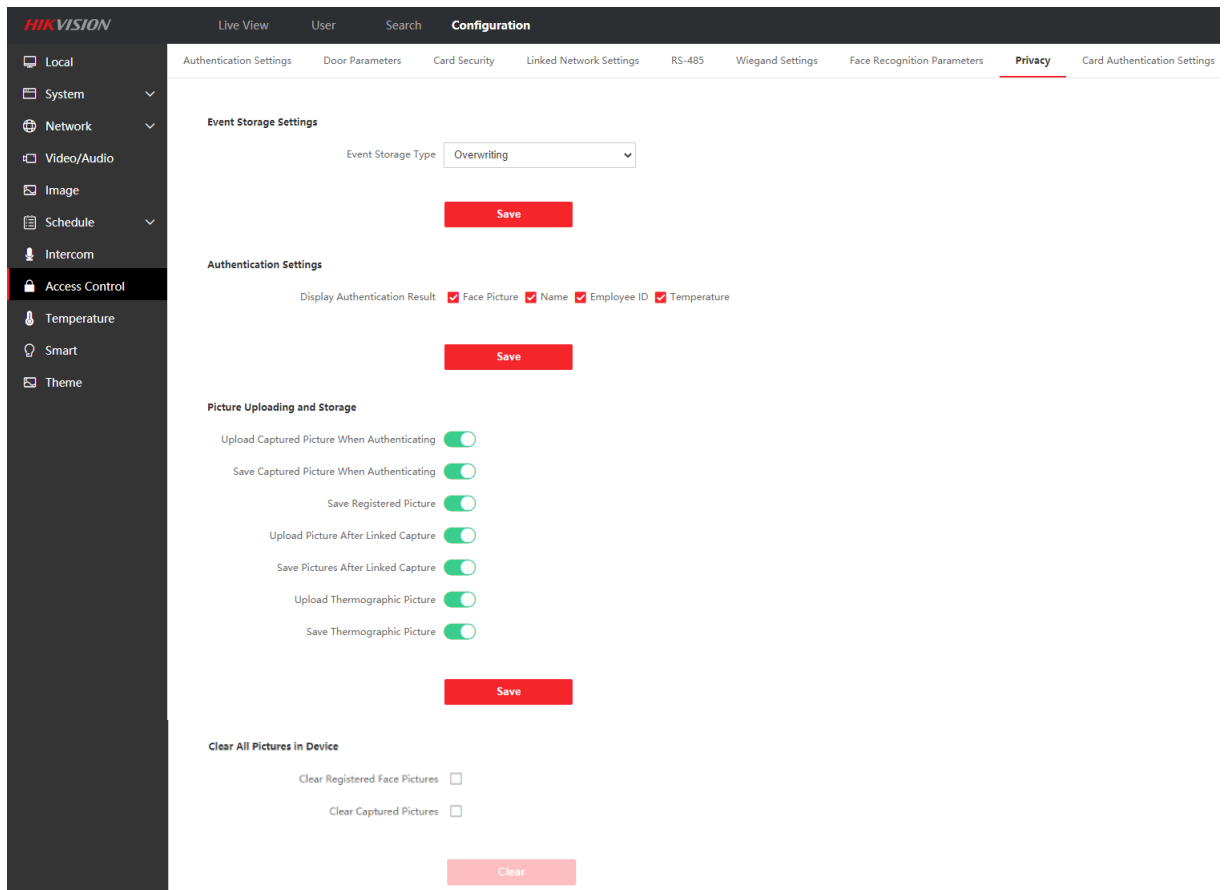

- Support PIN code only to open the door (disabled in default)

Note: PIN code should be configured from software, iVMS4200 already support, HikCentral Pro will support PIN code configuration in V2.1 expected to be released in June

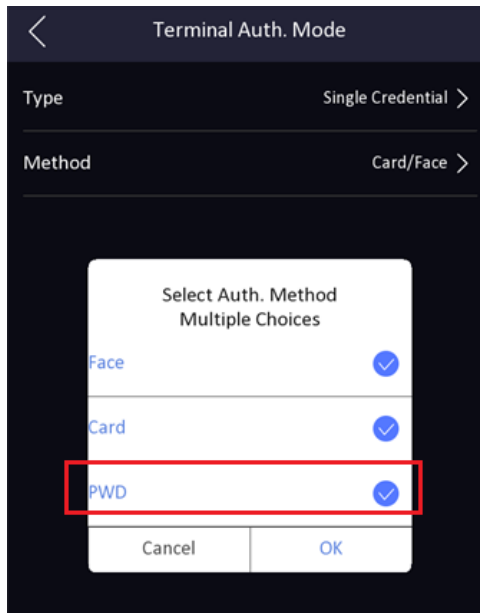

17. Network

Support TCP/IP and Wi-Fi (DS-K1T643MWX-T only), adapt to LAN (network) or WAN (ISUP 5.0) network environment

18. Function

- a. Video intercom with indoor station, master station, hik-connect mobile app and platform;

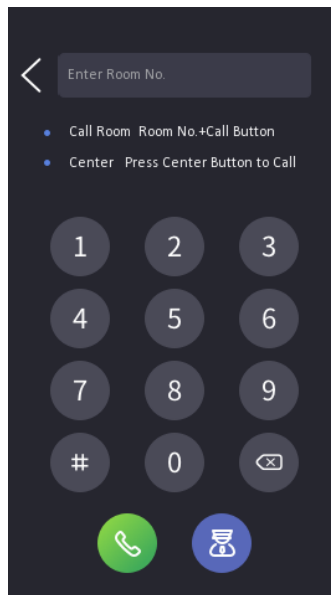

- b. Status bar shows device status in real time, include network status, deployment/arm status, Hik-Connect server connection status



- c. Multiple verification modes: Face, Card and PIN code;
- d. Face recognition distance ranges from 0.3 to 2 meters;

- e. Support check in/check out/break out/break in/overtime in/overtime out status, and attendance status name supports custom modification

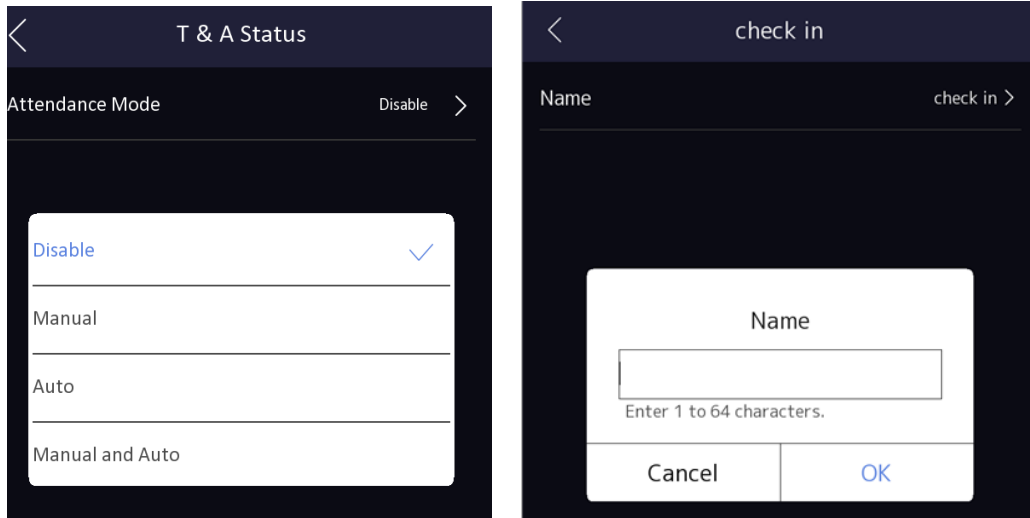

- f. Supports face recognition in low illumination
- g. Support http/https listening
- h. Support unbind device with hik-connect account on SADP tool, local UI and web

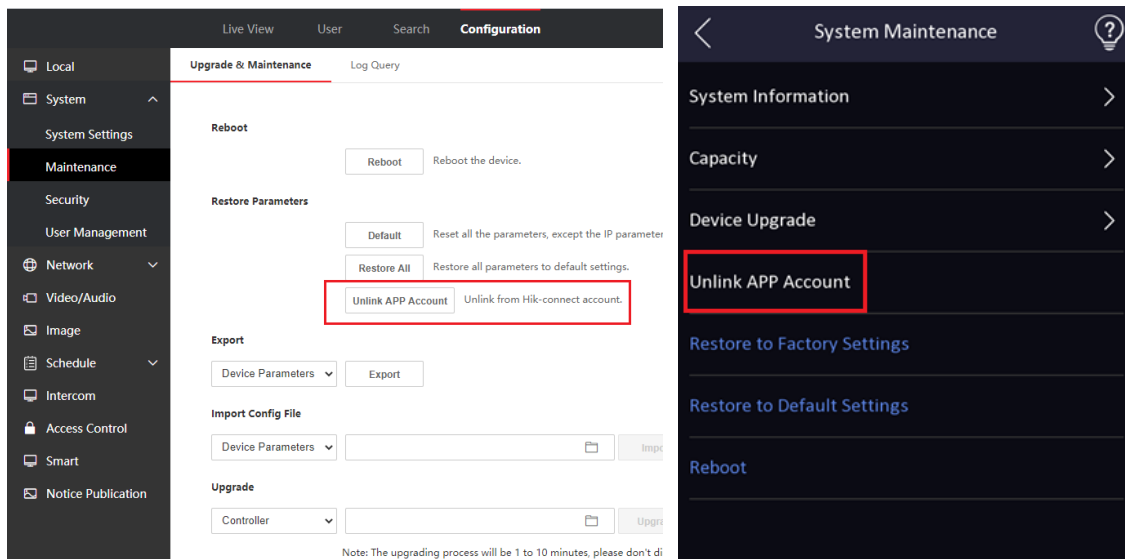
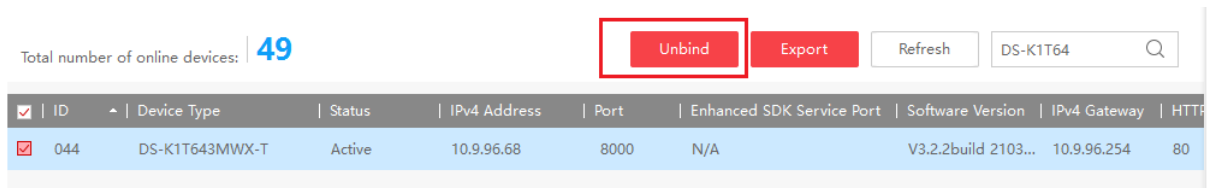

- i. Live view on the platform, H.264
- j. DNS can be configured from device UI in menu→Comm.-->Wired Network

Customer Impact and Recommended Action

This update refers to function/compatibility improvement and will take effect automatically after the Date of Change. We are very sorry for any inconvenience of use-habit changes caused by this action.

For any questions and request for this firmware, please contact our local technical support team.

Note:

- Hikvision reserves the right to change, alter or withdraw the above notification without prior notice.
- Product design and specifications are subject to change without prior notice.
- The Hikvision firmware may contain errors known as errata, which may cause the product to deviate from published specifications. Current characterized errata are available on request.
- Hikvision is not liable for any typing or printing errors.

Hikvision Digital Technology CO., Ltd.
No. 555 Qianmo Road, Binjiang District, Hangzhou 310051,
China
Tel: +86-571-8807-5998
FAX: +86-571-8993-5635
Email: overseabusiness@hikvision.com